

The **FANOSA® Construpanel** is a complete system consisting of a wide range of sustainable, lightweight and strong products thus making it ideal for any type of construction.

The panel is made from self-extinguishing expanded polystyrene sheets of various thicknesses and densities; both sides are reinforced with steel mesh with welded 3mm cross-connectors.

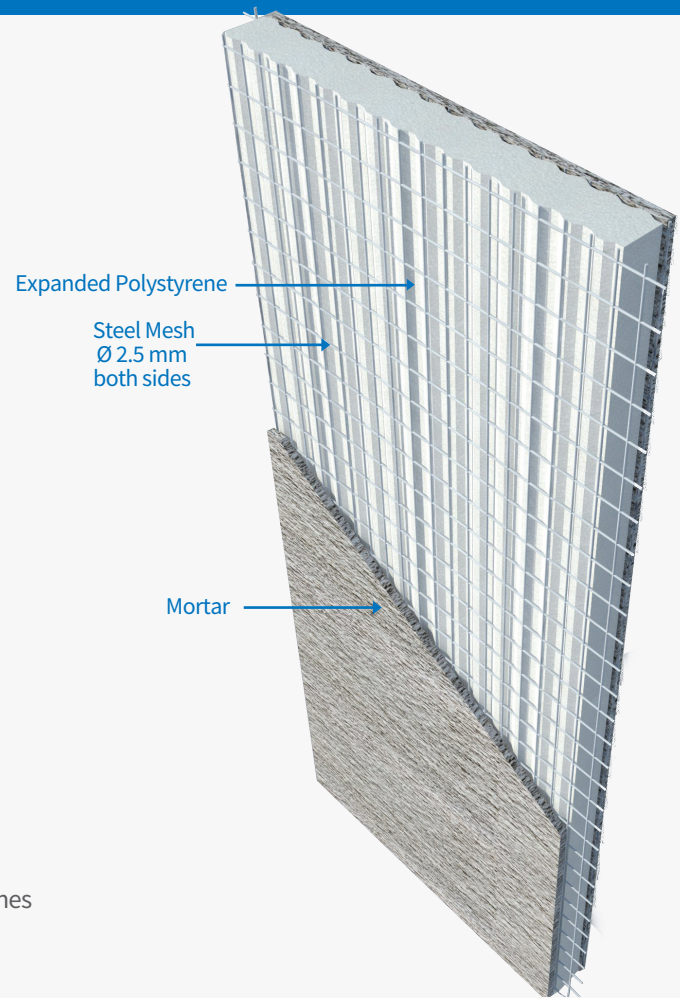

### Advantages

- > Sustainable & Energy Efficient
- > Lightweight
- > Quick installation
- > Convenient
- > Versatile
- > Load resistant
- > Fire resistant
- > Earthquake resistant
- > Cyclone resistant
- > Compatible with a variety of finishes

### COMPONENTS

#### > Construpanel



#### **Expanded polystyrene (EPS)**

The base element of the building system is a molded sheet of self-extinguishing expanded polystyrene with a density of 8 kg/m<sup>3</sup>, which functions as continuous thermal insulation.



#### **Steel Mesh**

The structural reinforcement is provided by a very strong steel mesh (2.5 mm in diameter), one mesh on each side of the plate, and joined with connectors measuring 3mm in diameter.



#### **Complement**

CONSTRUPANEL comprises the main component and is complemented with the application of a layer of shotcrete (mortar), having a resistance of at least 150 kg/cm<sup>2</sup> and a thickness of 2 to 2.5 cm on each side.

### STRUCTURAL CONSTRUPANEL

**Structural Construpanel** is an ideal both for new buildings, extensions or renovations as it is flexible and easily adapts to form curved elements.

It is used as a self-supporting structural element for buildings up to 6 floors. Its design lends itself for use as walls and slabs in both mezzanines and rooftops.

### PARTITION WALL CONSTRUPANEL

This is a lightweight and economical panel ideal for non-structural applications such as partition or plug walls. Its applications include any type of building, even industrial and commercial sectors, as it covers large areas in minimal time. Due to its design, **Partition Wall Construpanel** requires less surface mortar coverage.

### Product Presentation:

Available in 2", 3" and 4" thicknesses having a fixed width of 1.20 m and a length of 2.44 m; however, one of the huge advantages is that it can be custom manufactured to meet required thicknesses and lengths for special order projects.

